

Hadley DRYLINING

Standard Details

Hadley MF – Single Layer - Drawings



Hadley MF6A Perimeter Channel secured using suitable fixings at 600mm centres and within 50mm of each end.

Plasterboard to suit specification.

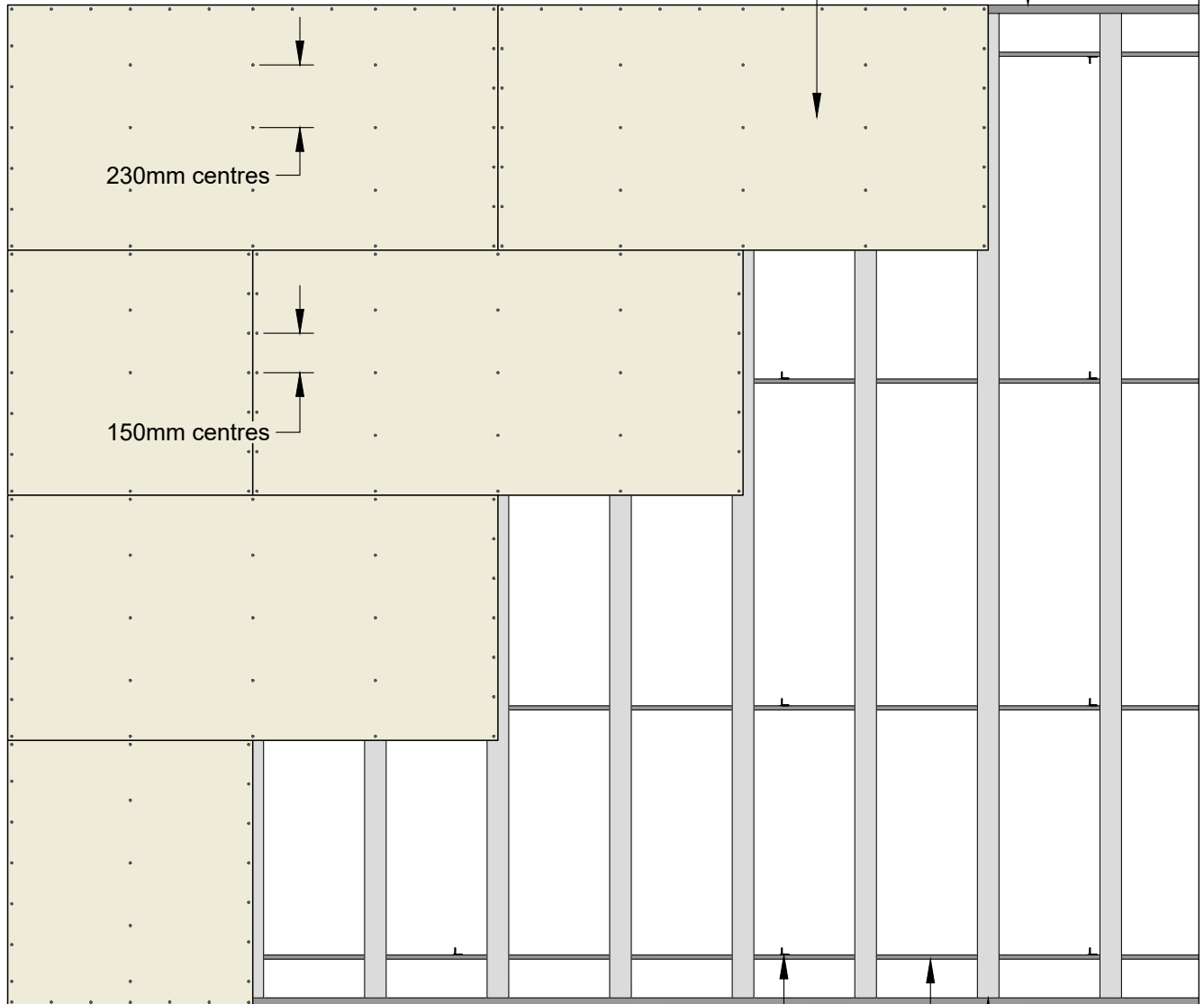

Hadley 25x25 Angle Hangers or Hadley Hanger Strap at centres to suit specification.

Hadley MF7 Primary Support Channel at centres to suit specification.

Hadley MF5 Ceiling Channel at 450mm centres maximum.

00	JUL21	First Issue	FM	JS	JS	System details to be read in conjunction with Hadley Group project specification pack. All applications to be built in accordance with British Standards, Building Regulations and Hadley Group tested solutions.
Rev:	Date:	Reason for Issue:	Drn:	Chk:	App:	

Project:

Typical System Detail
See project specification for exact requirements

Title:

Hadley MF Ceiling
Reflected Plan - Single Layer



Hadley Group, Downing Street,
Smethwick, West Midlands B66 2PA

Tel: +44 (0) 121 555 1329

E-mail: hct@hadleygroup.co.uk

Scale:	Date:	Drawn:	Checked:	Dwg No:	Revision:
1:25 @ A4	Jul 21	FM	JS	DRY-HAD-XX-ZZ-DT-X-1501	00

All performance data and system specifications are for systems constructed with materials & components as shown. The inclusion or substitution of any other manufacturers materials or components could invalidate test data and system performance. The information is provided in good faith and is based upon details received which are assumed to include all relevant facts. No duty of care is owed to the recipient or any other third party and Hadley Industries PLC cannot accept liability in respect of the details shown. None of the content may be distributed or copied directly without prior approval.

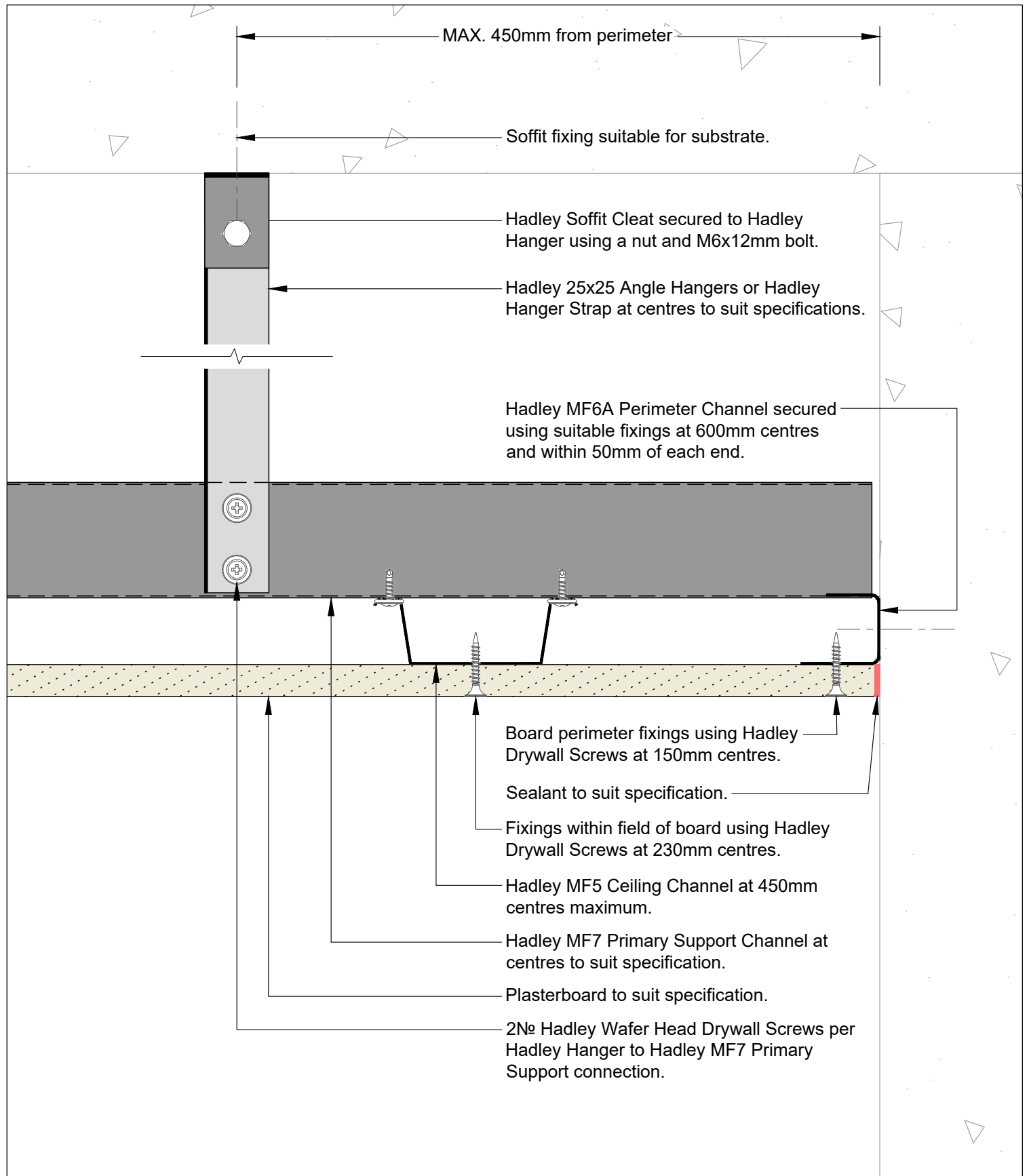

00	JUL21	First Issue	FM	JS	JS	System details to be read in conjunction with Hadley Group project specification pack. All applications to be built in accordance with British Standards, Building Regulations and Hadley Group tested solutions.
Rev:	Date:	Reason for Issue:	Drn:	Chk:	App:	

Project:
Typical System Detail
 See project specification for exact requirements

Title:
Hadley MF Ceiling
 Abutment to Masonry
 Parallel to MF5 Ceiling Channel

Scale:	Date:	Drawn:	Checked:	Dwg No:	Revision:
1:2 @ A4	Jul 21	FM	JS	DRY-HAD-XX-ZZ-DT-X-1502	00



Hadley Group, Downing Street,
 Smethwick, West Midlands B66 2PA
 Tel: +44 (0) 121 555 1329
 E-mail: hct@hadleygroup.co.uk

All performance data and system specifications are for systems constructed with materials & components as shown. The inclusion or substitution of any other manufacturers materials or components could invalidate test data and system performance. The information is provided in good faith and is based upon details received which are assumed to include all relevant facts. No duty of care is owed to the recipient or any other third party and Hadley Industries PLC cannot accept liability in respect of the details shown. None of the content may be distributed or copied directly without prior approval.

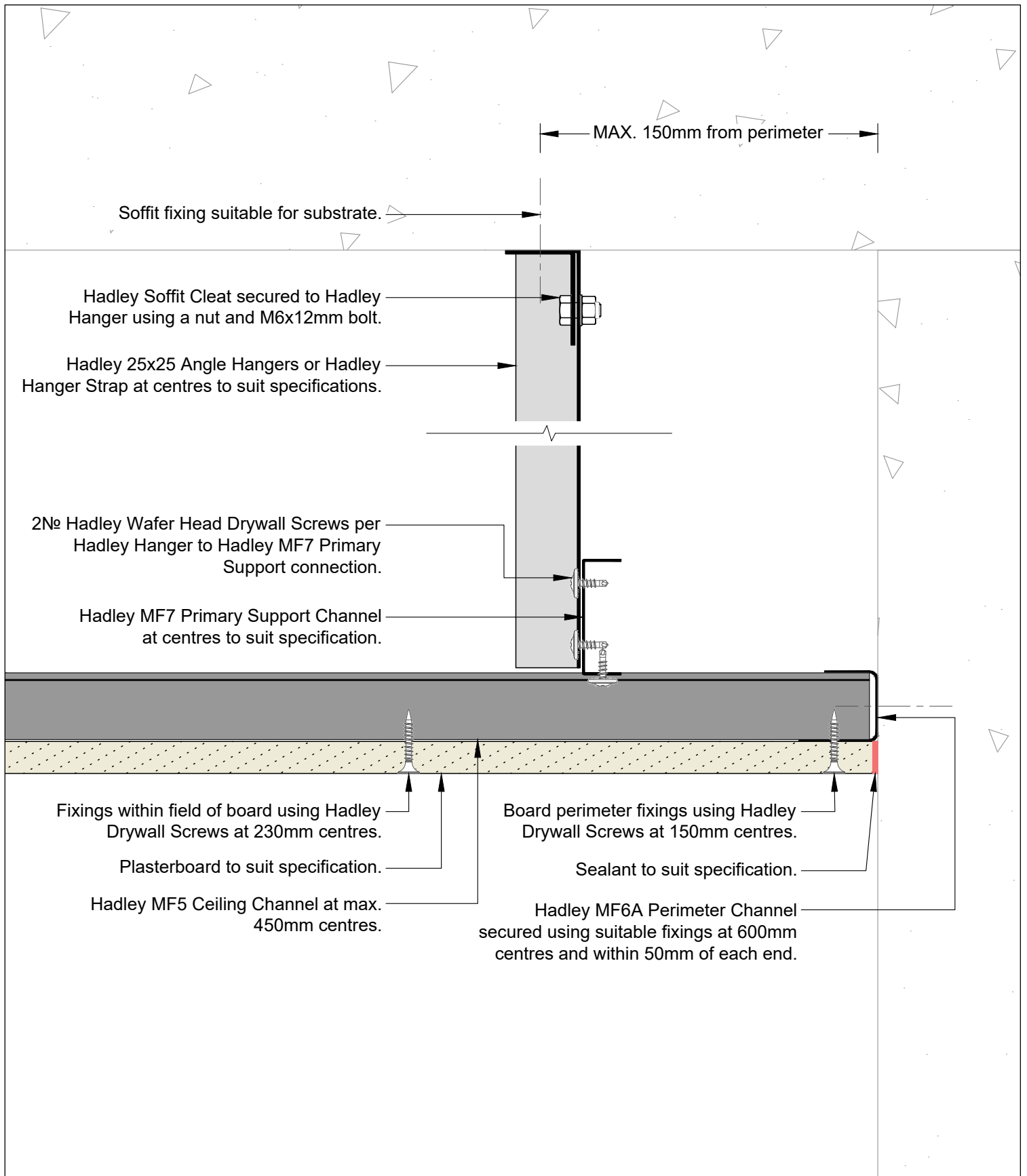

00	JUL21	First Issue	FM	JS	JS	System details to be read in conjunction with Hadley Group project specification pack. All applications to be built in accordance with British Standards, Building Regulations and Hadley Group tested solutions.
Rev:	Date:	Reason for Issue:	Drn:	Chk:	App:	

Project:
Typical System Detail
 See project specification for exact requirements

Title:
Hadley MF Ceiling
 Abutment to Masonry
 Perpendicular to MF5 Ceiling Channel



Hadley Group, Downing Street,
 Smethwick, West Midlands B66 2PA
 Tel: +44 (0) 121 555 1329
 E-mail: hct@hadleygroup.co.uk

Scale:	Date:	Drawn:	Checked:	Dwg No:	Revision:
1:2 @ A4	Jul 21	FM	JS	DRY-HAD-XX-ZZ-DT-X-1503	00

All performance data and system specifications are for systems constructed with materials & components as shown. The inclusion or substitution of any other manufacturers materials or components could invalidate test data and system performance. The information is provided in good faith and is based upon details received which are assumed to include all relevant facts. No duty of care is owed to the recipient or any other third party and Hadley Industries PLC cannot accept liability in respect of the details shown. None of the content may be distributed or copied directly without prior approval.

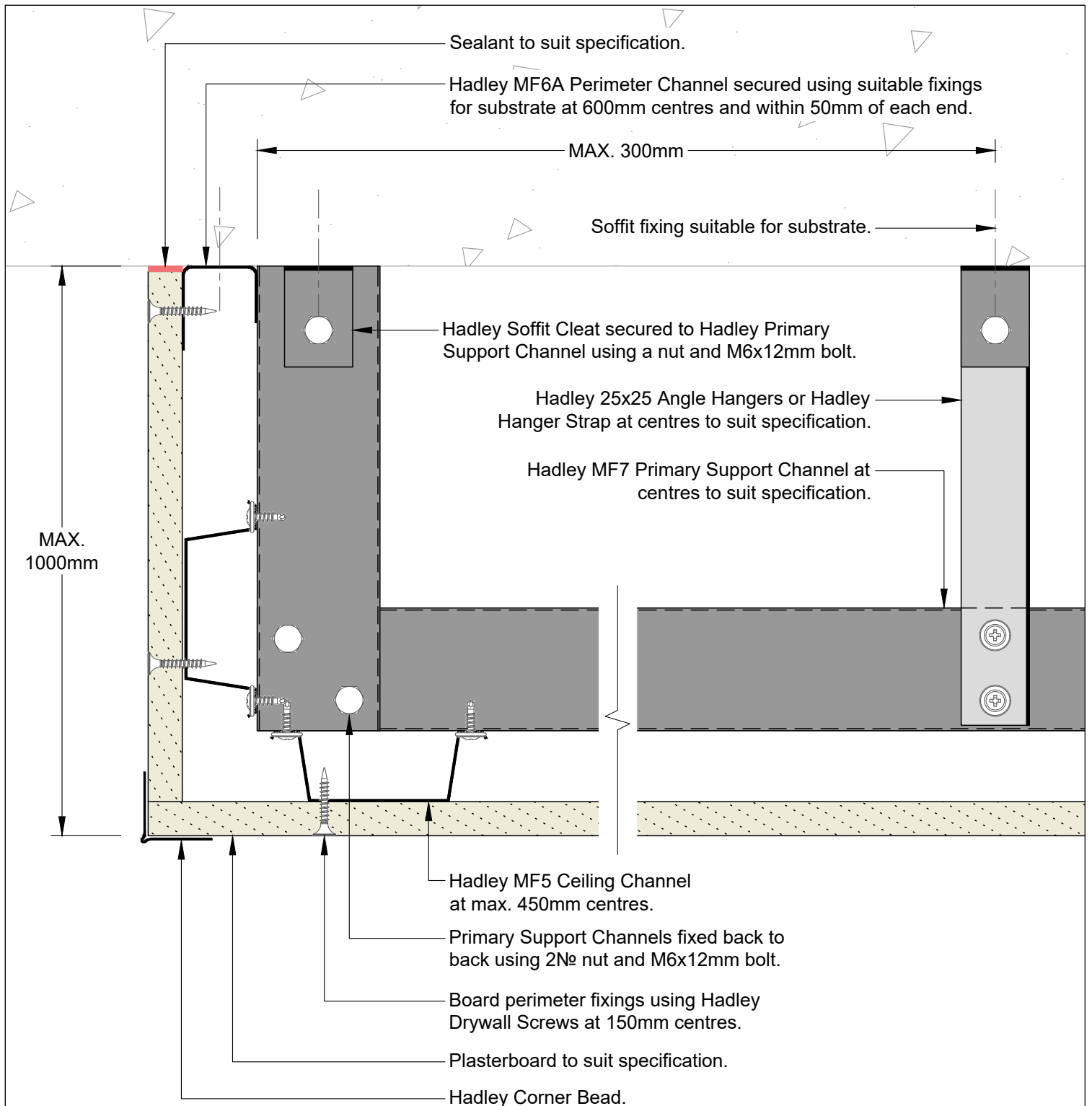

00	JUL21	First Issue	FM	JS	JS	System details to be read in conjunction with Hadley Group project specification pack. All applications to be built in accordance with British Standards, Building Regulations and Hadley Group tested solutions.
Rev:	Date:	Reason for Issue:	Drn:	Chk:	App:	

Project:
Typical System Detail
 See project specification for exact requirements

Title:
Hadley MF Ceiling Bulkhead
 Parallel to MF5 Ceiling Channel



Hadley Group, Downing Street,
 Smethwick, West Midlands B66 2PA
 Tel: +44 (0) 121 555 1329
 E-mail: hct@hadleygroup.co.uk

Scale:	Date:	Drawn:	Checked:	Dwg No:	Revision:
1:2 @ A4	Jul 21	FM	JS	DRY-HAD-XX-ZZ-DT-X-1504	00

All performance data and system specifications are for systems constructed with materials & components as shown. The inclusion or substitution of any other manufacturers materials or components could invalidate test data and system performance. The information is provided in good faith and is based upon details received which are assumed to include all relevant facts. No duty of care is owed to the recipient or any other third party and Hadley Industries PLC cannot accept liability in respect of the details shown. None of the content may be distributed or copied directly without prior approval.

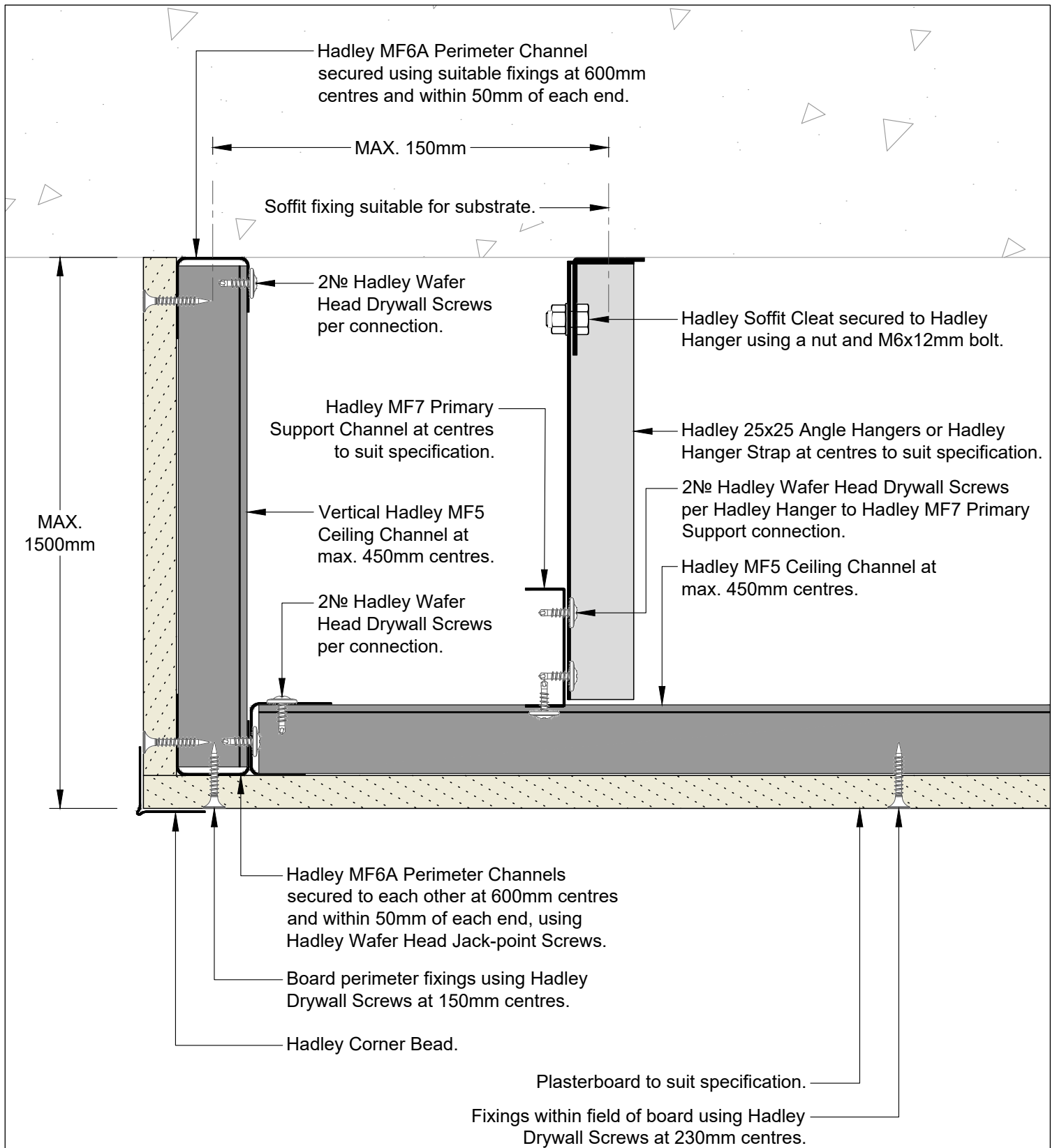

00	JUL21	First Issue	FM	JS	JS	System details to be read in conjunction with Hadley Group project specification pack. All applications to be built in accordance with British Standards, Building Regulations and Hadley Group tested solutions.
Rev:	Date:	Reason for Issue:	Drn:	Chk:	App:	

Project:
Typical System Detail
 See project specification for exact requirements

Title:
Hadley MF Ceiling
 Bulkhead
 Perpendicular to MF5 Ceiling Channel



Hadley Group, Downing Street,
 Smethwick, West Midlands B66 2PA
 Tel: +44 (0) 121 555 1329
 E-mail: hct@hadleygroup.co.uk

Scale:	Date:	Drawn:	Checked:	Dwg No:	Revision:
1:2 @ A4	Jul 21	FM	JS	DRY-HAD-XX-ZZ-DT-X-1505	00

All performance data and system specifications are for systems constructed with materials & components as shown. The inclusion or substitution of any other manufacturers materials or components could invalidate test data and system performance. The information is provided in good faith and is based upon details received which are assumed to include all relevant facts. No duty of care is owed to the recipient or any other third party and Hadley Industries PLC cannot accept liability in respect of the details shown. None of the content may be distributed or copied directly without prior approval.

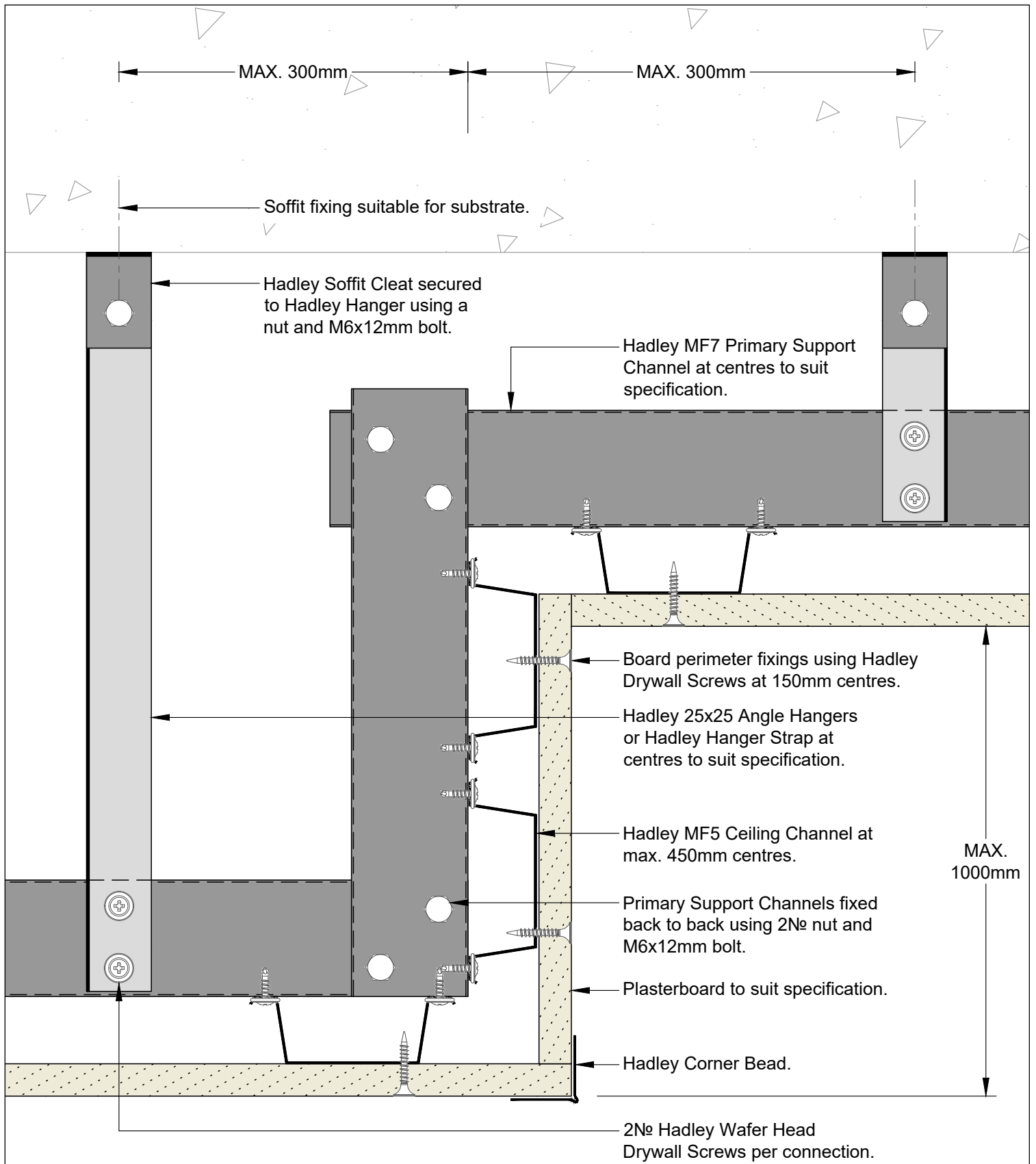

00	JUL21	First Issue	FM	JS	JS	System details to be read in conjunction with Hadley Group project specification pack. All applications to be built in accordance with British Standards, Building Regulations and Hadley Group tested solutions.
Rev:	Date:	Reason for Issue:	Drn:	Chk:	App:	

Project:
Typical System Detail
 See project specification for exact requirements

Title:
Hadley MF Ceiling
 Change of Level
 Parallel to MF5 Ceiling Channel



Hadley Group, Downing Street,
 Smethwick, West Midlands B66 2PA
 Tel: +44 (0) 121 555 1329
 E-mail: hct@hadleygroup.co.uk

Scale: 1:2 @ A4	Date: Jul 21	Drawn: FM	Checked: JS	Dwg No: DRY-HAD-XX-ZZ-DT-X-1506	Revision: 00
--------------------	-----------------	--------------	----------------	---	------------------------

All performance data and system specifications are for systems constructed with materials & components as shown. The inclusion or substitution of any other manufacturers materials or components could invalidate test data and system performance. The information is provided in good faith and is based upon details received which are assumed to include all relevant facts. No duty of care is owed to the recipient or any other third party and Hadley Industries PLC cannot accept liability in respect of the details shown. None of the content may be distributed or copied directly without prior approval.

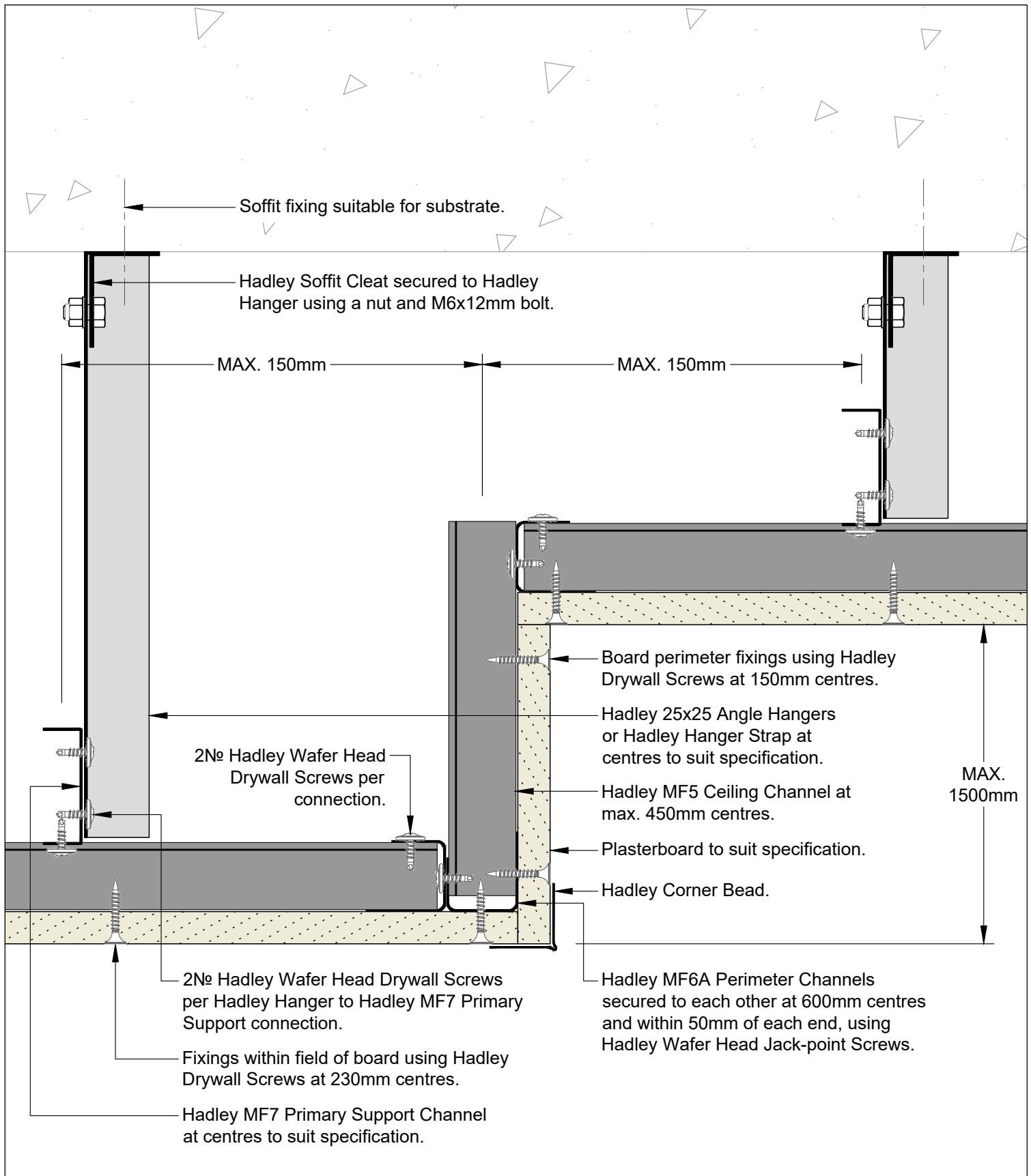

00	JUL21	First Issue	FM	JS	JS	System details to be read in conjunction with Hadley Group project specification pack. All applications to be built in accordance with British Standards, Building Regulations and Hadley Group tested solutions.
Rev:	Date:	Reason for Issue:	Drn:	Chk:	App:	

Project:
Typical System Detail
 See project specification for exact requirements

Title:
Hadley MF Ceiling
 Change of Level
 Perpendicular to MF5 Ceiling Channel



Hadley Group, Downing Street,
 Smethwick, West Midlands B66 2PA
 Tel: +44 (0) 121 555 1329
 E-mail: hct@hadleygroup.co.uk

Scale:	Date:	Drawn:	Checked:	Dwg No:	Revision:
1:2 @ A4	Jul 21	FM	JS	DRY-HAD-XX-ZZ-DT-X-1507	00

All performance data and system specifications are for systems constructed with materials & components as shown. The inclusion or substitution of any other manufacturers materials or components could invalidate test data and system performance. The information is provided in good faith and is based upon details received which are assumed to include all relevant facts. No duty of care is owed to the recipient or any other third party and Hadley Industries PLC cannot accept liability in respect of the details shown. None of the content may be distributed or copied directly without prior approval.

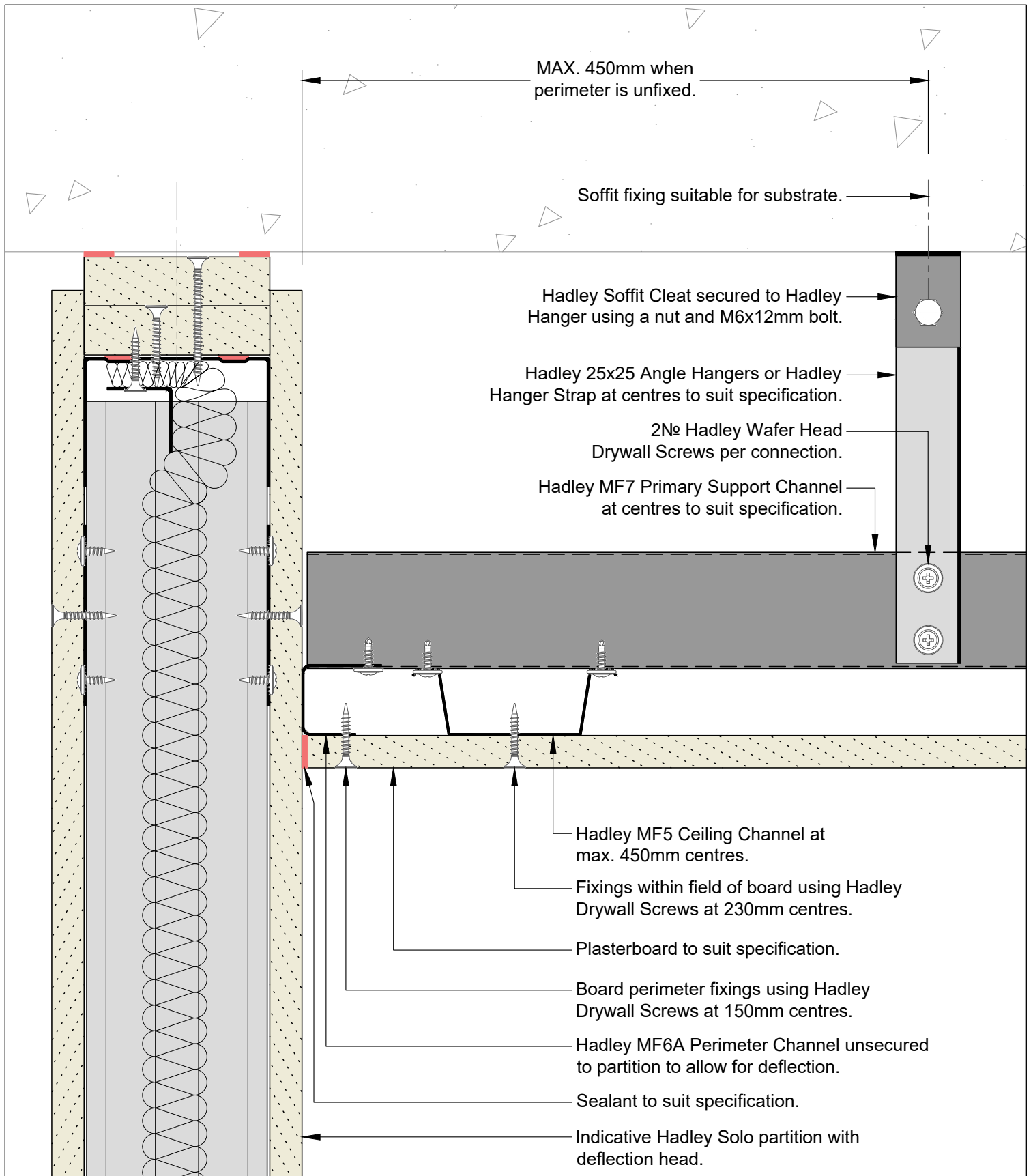

00	JUL21	First Issue	FM	JS	JS	System details to be read in conjunction with Hadley Group project specification pack. All applications to be built in accordance with British Standards, Building Regulations and Hadley Group tested solutions.
Rev:	Date:	Reason for Issue:	Drn:	Chk:	App:	

Project:
Typical System Detail
 See project specification for exact requirements

Title:
Hadley MF Ceiling
 Abutment to Partition with deflection
 Parallel to MF5 Ceiling Channel



Hadley Group, Downing Street,
 Smethwick, West Midlands B66 2PA
 Tel: +44 (0) 121 555 1329
 E-mail: hct@hadleygroup.co.uk

Scale:	Date:	Drawn:	Checked:	Dwg No:	Revision:
1:2 @ A4	Jul 21	FM	JS	DRY-HAD-XX-ZZ-DT-X-1508	00

All performance data and system specifications are for systems constructed with materials & components as shown. The inclusion or substitution of any other manufacturers materials or components could invalidate test data and system performance. The information is provided in good faith and is based upon details received which are assumed to include all relevant facts. No duty of care is owed to the recipient or any other third party and Hadley Industries PLC cannot accept liability in respect of the details shown. None of the content may be distributed or copied directly without prior approval.

© 2021 Hadley Industries Holdings Limited

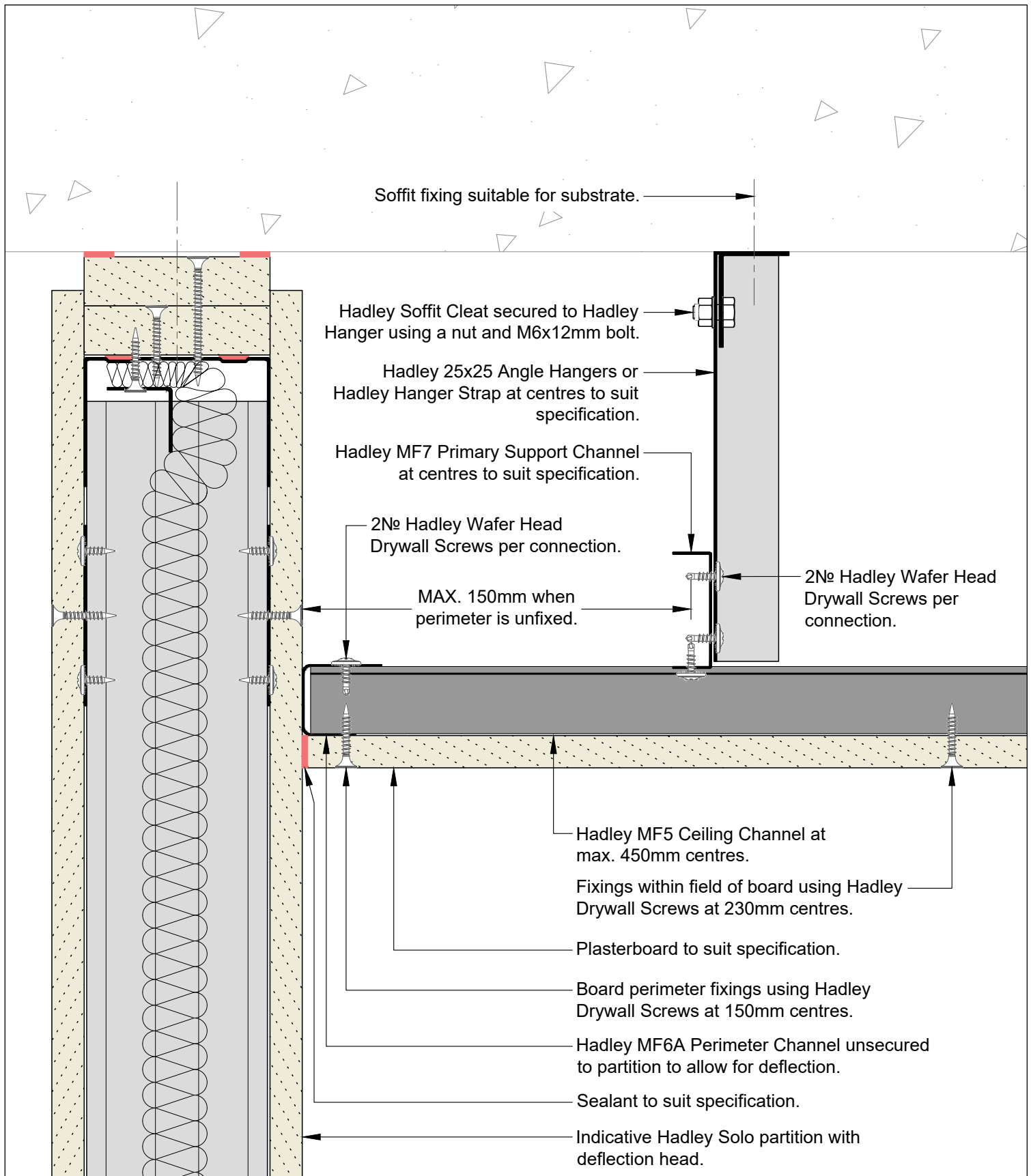

00	JUL21	First Issue	FM	JS	JS	System details to be read in conjunction with Hadley Group project specification pack. All applications to be built in accordance with British Standards, Building Regulations and Hadley Group tested solutions.
Rev:	Date:	Reason for Issue:	Drn:	Chk:	App:	

Project:
Typical System Detail
 See project specification for exact requirements

Title:
Hadley MF Ceiling
 Abutment to Partition with deflection
 Perpendicular to MF5 Ceiling Channel



Hadley Group, Downing Street,
 Smethwick, West Midlands B66 2PA
 Tel: +44 (0) 121 555 1329
 E-mail: hct@hadleygroup.co.uk

Scale:	Date:	Drawn:	Checked:	Dwg No:	Revision:
1:2 @ A4	Jul 21	FM	JS	DRY-HAD-XX-ZZ-DT-X-1509	00

All performance data and system specifications are for systems constructed with materials & components as shown. The inclusion or substitution of any other manufacturers materials or components could invalidate test data and system performance. The information is provided in good faith and is based upon details received which are assumed to include all relevant facts. No duty of care is owed to the recipient or any other third party and Hadley Industries PLC cannot accept liability in respect of the details shown. None of the content may be distributed or copied directly without prior approval.

© 2021 Hadley Industries Holdings Limited