

HadleyMF

Installation Guide – Method Statement



HadleyMF

HadleyMF is a suspended ceiling system able to create a void to hide any services. Easy to install and able to reduce installation times on site. This system is non-firerated.

This method statement covers the construction of a suspended ceiling system. The suspended ceiling will be installed in a building to create a ceiling grid using metal Hadley components and gypsum plasterboards (drywall), and associated fixings.

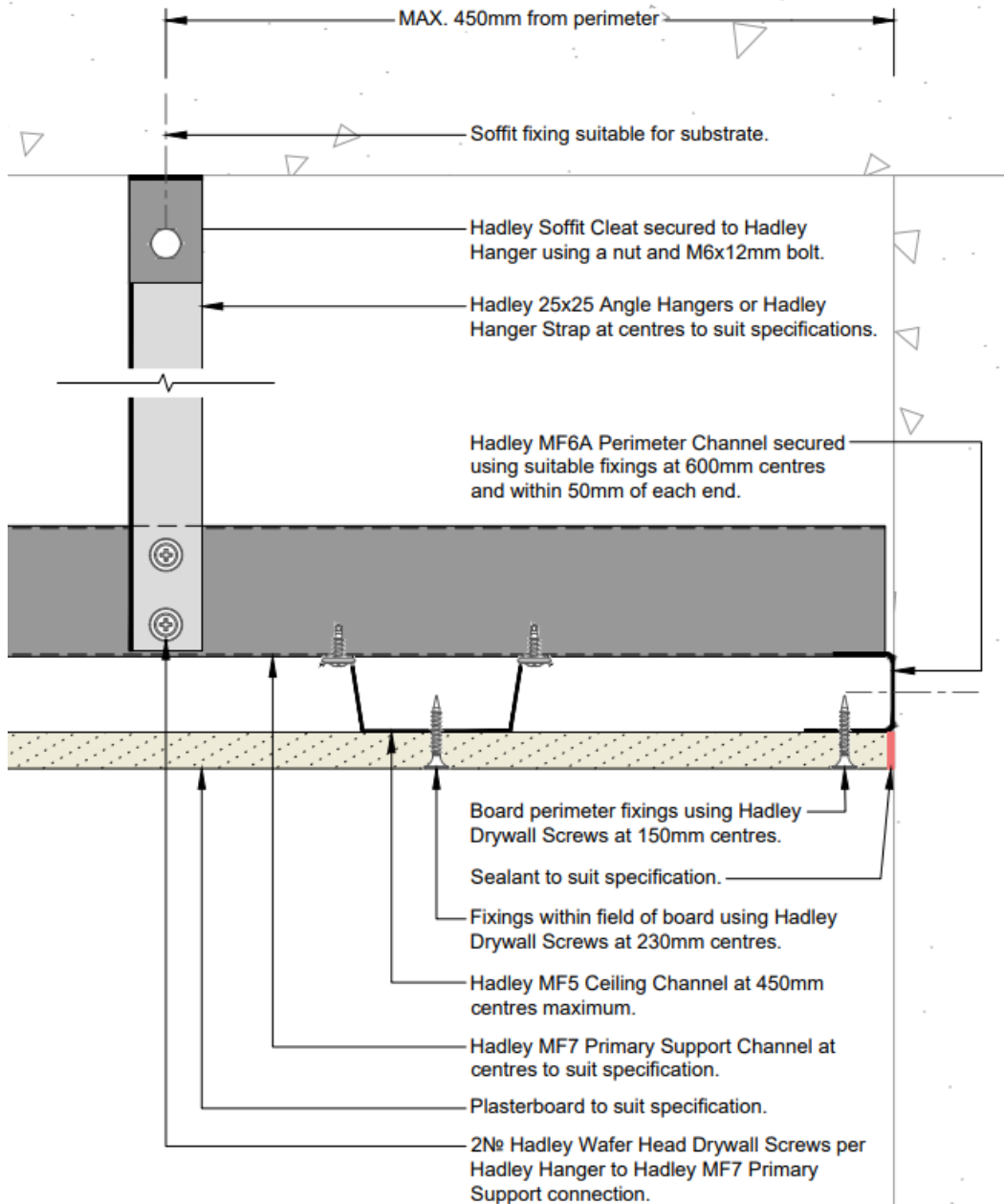

MATERIALS

- Hadley MF5 Ceiling Channel
- Hadley MF6A Perimeter Channel
- Hadley MF7 Primary Support Channel
- Gypsum Plasterboard
- Drywall Screws
- Jointing compound
- Joint Tape
- Corner beads (if needed)
- Insulation (to suit specification)
- Intumescent and acoustic sealant
- Hadley Angle

TOOLS

- Power Drill
- Screwdriver
- Measuring Tape
- Spirit Level
- Chalk Line
- Trowel

PPE

- High visibility wear
- Steel-Toe Cap shoes
- Hard Hat
- Gloves
- Safety Glasses
- Hearing Protection

PREPARATION

Risk Assessment

Conduct a risk assessment before starting work. Highlight any specific risks such as working with power tools or working at height (if applicable).

Site Survey

Confirm the location and dimensions of the ceiling as per the approved specification and HadleyMF Standard details.

Check Structural Elements

Ensure that the ceiling and floor structure is suitable for fixing the ceiling.

Prepare Tools and Materials

Ensure all required tools and materials are on site and in good working order.

Make sure you are following all recommended industry and company H&S standards and policies.

INSTALLATION GUIDE

HadleyMF

Mark the Ceiling Location:

Mark the ceiling line on the walls using a laser or spirit level, ensuring it is level around the entire perimeter of the room.

Identify the positions for the ceiling suspension points (usually every 1200mm:check Hadley specification for centres).

Mark the locations of ceiling hangers or fixings at regular intervals (usually every 1200mm:check Hadley specification for centres).

① Fixing the Hadley MF6A Perimeter Channel:

Install the perimeter metal channel along the marked ceiling line on the walls.

Use suitable fixings to secure the perimeter channel to the walls at 600mm centres and within 50mm of each end.

Ensure the channel is level and properly aligned.

② Suspending the Main Channels:

Attach soffit cleats to the soffit using suitable fixings.

Attach the Hadley 25x25 Angle hangers to the soffit cleats using a nut and M6x12mm bolt.

Adjust the height of the channels to align with the previously marked ceiling line.

Suspend the Hadley MF7 Primary Support Channel from the ceiling hangers at the correct spacing (usually every 1200mm:check Hadley specification for centres).

Use 2x Wafer head drywall screws per Hadley hanger to fix Hadley MF7 Primary Support connection.

Install the Hadley MF5 ceiling channel to the underside of the MF7 Primary Support Channel at maximum 450mm centres with 2 x wafer head screws each side of the channel.

③ Install Plasterboard:

Lift the plasterboard panels into position and secure them to the cross furring channels using drywall screws or nails.

Ensure the boards are tightly joined, with a small gap between the edge of the boards and the walls for expansion.

continue installing plasterboard across the ceiling, ensuring each board is securely fastened.

studs.

Plasterboard should be Screw fixed at maximum 300mm centres with centres reduced to 200mm at all corners.

Ensure all plasterboard panels are securely attached and the joints are flush

④ Jointing:

To help maintain performance we recommend all joints are taped and jointed.

Apply joint compound to the joints between Plasterboard and embed joint tape into the compound.

Smooth out the compound, ensuring a seamless finish.

Apply additional coats of joint compound as necessary, allowing drying time between coats.

Sand the joints once dry for a smooth finish.

⑥ Insulation (if specified):

If insulation is required, install it above the Hadley MF7 Primary Support Channel before applying the plasterboard. Following the Insulation manufacturer's instructions

7 Final Check:

Ensure the ceiling is level and square in accordance with BS8000-8:2023

Inspect drywall joints and finishes for smoothness and uniformity.

Clean the work area, removing any debris or leftover materials.

- **Quality Control**

Check the alignment and level of the ceiling regularly during installation.

Verify that all joints and corners are finished smoothly and without visible defects.

Ensure all Plasterboards are securely fastened and that screws are not overdriven.

- **Completion**

Once the ceiling is installed and the jointing is complete, allow sufficient time for drying. The ceiling should be ready for painting or further finishing as specified.

- **Hand Over**

Ensure the area is clean and safe before handover.

Provide any necessary documentation, such as material specifications or maintenance instructions.

All installations should comply with Hadley Group recommendations, BS8000-8 2023 and all other relevant guidance and regulations. If anything is unclear, please contact us for further clarification.

For further information on how to construct more bespoke detailing the below please refer to our HadleyDRYLINING Standard Details where we have examples of deflection heads - openings - door openings - socket boxes - movement control joints & more.

Your questions answered.

You can rely on the Hadley Group to provide full specification and detailed system data with technical drawings tailored to your project needs.

With years of experience, our Technical Team will work closely with you to provide advice through our support hotline [0121 555 1329](tel:01215551329), open 8:30-17:00 Monday to Friday (exc. Bank holidays).

DRY-HAD-XX-ZZ-TE-X-308

Version	Date	Prepared	App' HCT #1	App' HCT #2	Notes
1.0	11/11/2024	FM	FM	JS	First Version



Hadley Group, Downing Street,
Smethwick, West Midlands,
B66 2PA

+44 (0) 121 555 1300
+44 121 820 6500
hct@hadleygroup.com